

# COPAL

## LB16MG-500-AB 16mm Brushless Motor Planetary Metal Gearbox 12Vdc, 500:1 Ratio

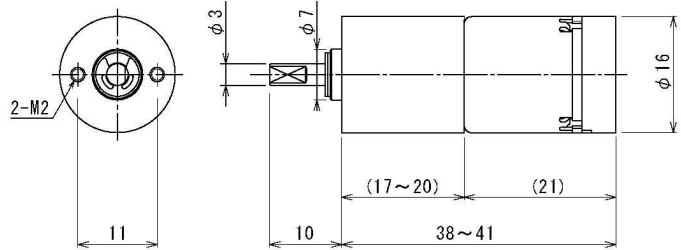

**RoHS Compliant**

Drive Electronics :Internal  
 Gearbox :Planetary Metal Gears  
 Bearing Type :Sleeve  
 Rotation :CW; CCW  
 Operating Temp :0°C~50°C  
 Net Weight :33.5g

| Model         | Rated Voltage (Vdc) | Rated Current (mA) | Starting Current (mA) | Rated Torque |     | Starting Torque |      | Rated Speed (rpm) | No Load Speed (rpm) | Length (mm) |
|---------------|---------------------|--------------------|-----------------------|--------------|-----|-----------------|------|-------------------|---------------------|-------------|
|               |                     |                    |                       | oz-in        | mNm | oz-in           | mNm  |                   |                     |             |
| LB16MG-500-AB | 12                  | 200                | 1100                  | 27.8         | 196 | 283             | 2000 | 23                | 25                  | 41          |

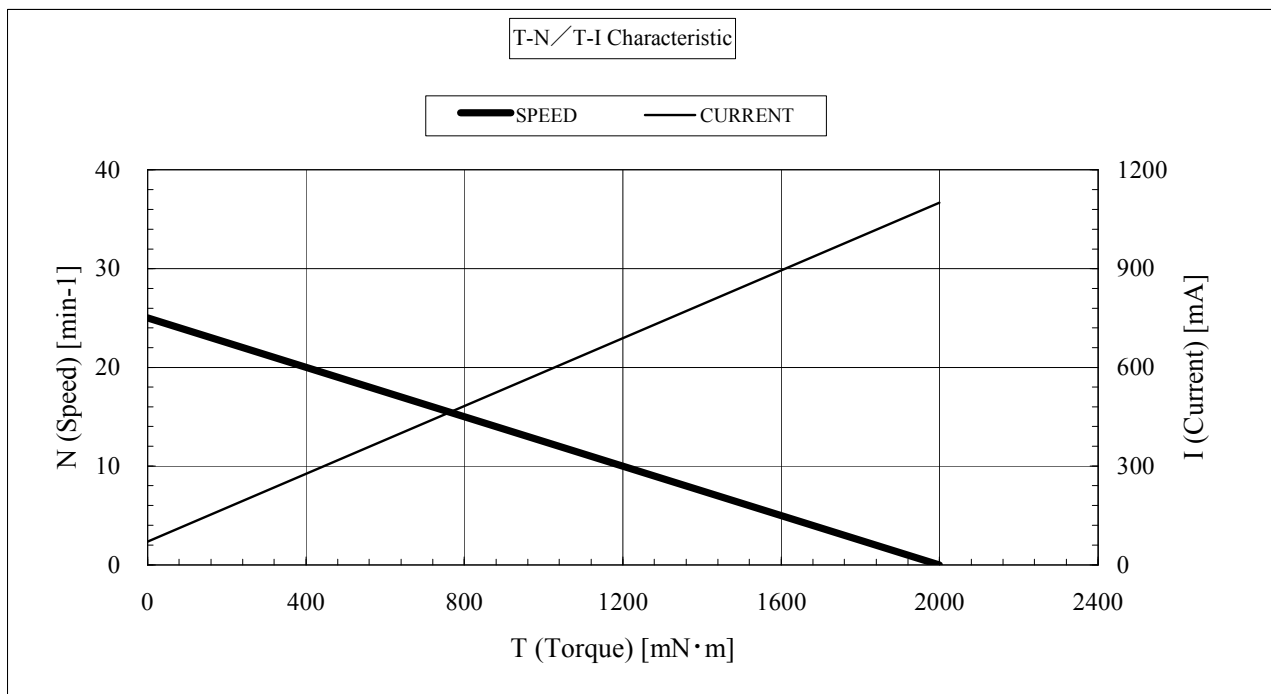

## Input/Output Signal

| Wire No. | Item                 | Standard  | Wire Color |
|----------|----------------------|---|------------|
| 1        | GND                  |   | Black      |
| 2        | VM (motor power)     | 3.5~13.2VDC (Motor Speed Control)                             | Gray       |
| 3        | Vcc (driver circuit) | 12VDC: (10.8~13.2VDC)   | Red        |
| 4        | CW/CCW               | CW: to Vcc; CCW: to GND                                       | Green      |
| 5        | FG                   | P-P: GND to Vcc 2036 P/R (Gear Ratio×4)<br>Square wave signal | Yellow     |

### **Nidec Copal (U.S.A.) Corporation**

373 Van Ness Ave Suite 130

Torrance, CA 90501

Tel: (310) 782-6102

Fax: (310) 782-6821

[www.nidec-copal-usa.com](http://www.nidec-copal-usa.com)

[info@nidec-copal-usa.com](mailto:info@nidec-copal-usa.com)