

COPAL 37mm Gear Motor HG37 Series 120:1 Ratio



Case : Metal
 Bearing : Sleeve Bearing
 Operating Temp : 0°C~50°C
 Rotation : CW, CCW
 Net Weight : 155g

- Resin gears for quiet operation
- Planetary gearbox
- Special configurations available upon request
- RoHS Compliant

Model	Rated Voltage (DC)	Operating Voltage (DC)	Rated Current (mA)	Stall Current (mA)	Rated Torque		Stall Torque		Rated Speed (rpm)	No Load Speed (rpm)
					oz-in	N-cm	oz-in	N-cm		
HG37-120-AA	12	10.8~13.2	350	1500	55.5	39.2	208	147	33	41
HG37-120-AB	24	21.6~26.4	200	750						

OUTLINE DIMENSIONS

(Unit: mm)

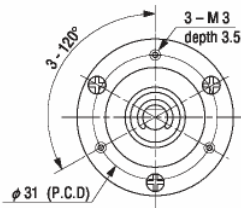

L= 20mm

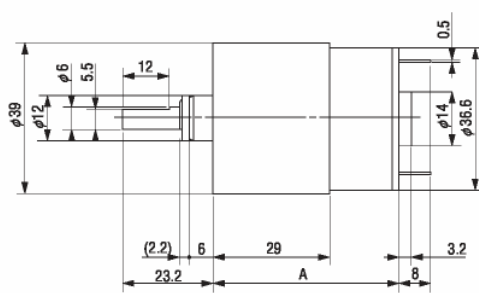

A=52mm

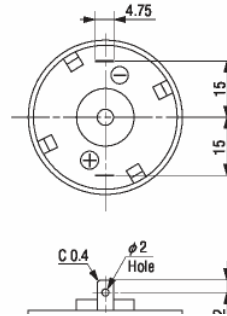

Nidec Copal (U.S.A.) Corp.
 373 Van Ness Ave Suite 130
 Torrance, CA 90501
 Tel: (310) 782-6102
 Fax: (310) 782-6821
www.nidec-copal-usa.com
info@nidec-copal-usa.com

